

An example of L Seating

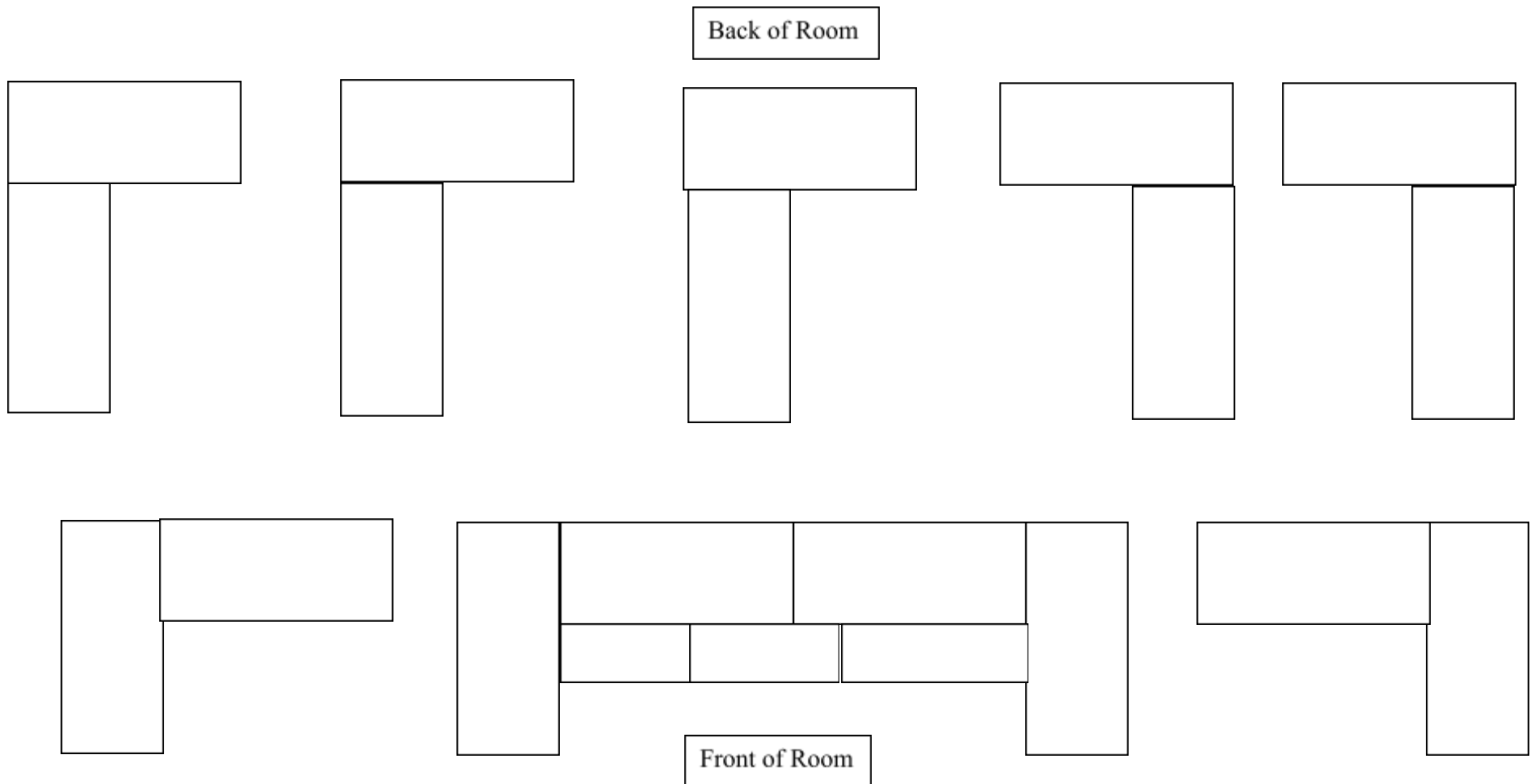

This is how I used to have my room set up with two-person black lab tables. I had seating for 36 students, and if I had 32 or fewer in a class I'd usually keep the back middle L empty. If I never had more than 32 in a class in a particular year I'd remove that middle L entirely and move the others more to the middle (the asymmetry of this set-up always annoyed me). I assigned seats strategically to make each L a mix of skills and strengths based on both academic data and student surveys. For testing days, when I wanted more privacy, I could just rotate the ones that are vertical in this graphic to get rows. —Jay Schauer